

## Thermoelectric cooler



### Description

<b>Order Number:</b>	0901986980
<b>Brand Name:</b>	SoliTherm
<b>Housing Material:</b>	Stainless steel AISI 304 (V2A)
<b>Ingress protection to EN 60 529:</b>	IP 66 / UL Type 12, 4, 4X
<b>Note:</b>	The torque for the mounting nuts should be 4.5 Nm.
<b>Approvals:</b>	CE, cURus

## Technical data

<b>Cooling capacity 95F/95F:</b>	170 BTU
<b>Air volume flow (system / unimpeded):</b>	Ambient air circuit: 37 / 100 cfm Cabinet air circuit: 13 / 42 cfm
<b>Operating temperature range:</b>	-4°F - 158°F
<b>UL temperature range:</b>	-4°F - 149°F
<b>Mounting:</b>	Recessed
<b>Dimension H x W x D:</b>	206 x 154 x 135 mm
<b>Weight:</b>	7 lbs.
<b>Cut out dimensions:</b>	170 x 120 mm
<b>Voltage / Frequency:</b>	24 V DC
<b>Current 95F95F:</b>	2.4 A
<b>Starting current:</b>	3.7 A
<b>Max. current:</b>	2.8 A
<b>Nominal power 95F95F:</b>	57.6 W
<b>Max. power:</b>	66 W
<b>Fuse:</b>	4 A (T)
<b>Connection:</b>	Connection terminal block

**Performance graph:**

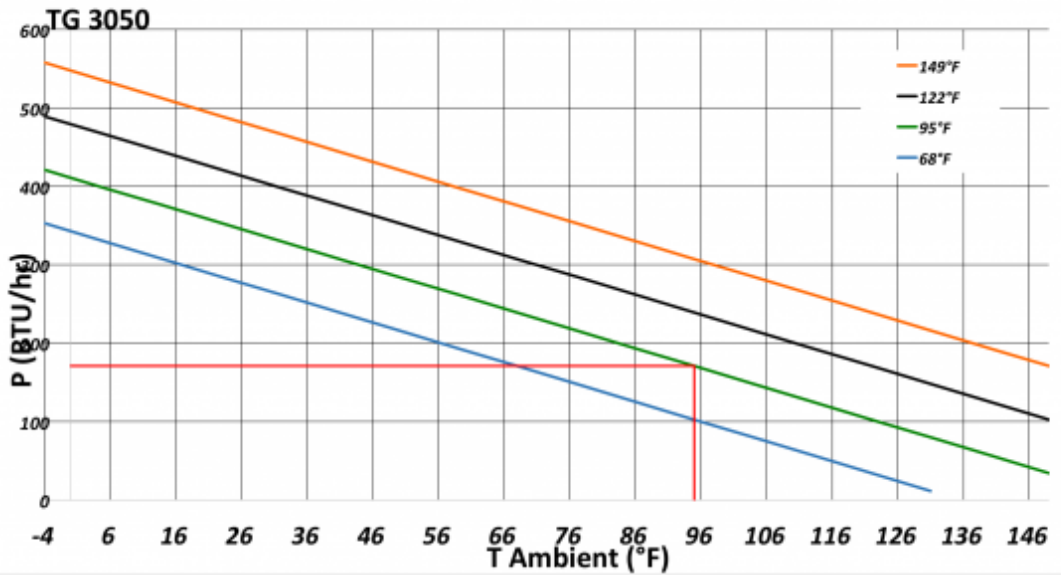

**Air flow:**

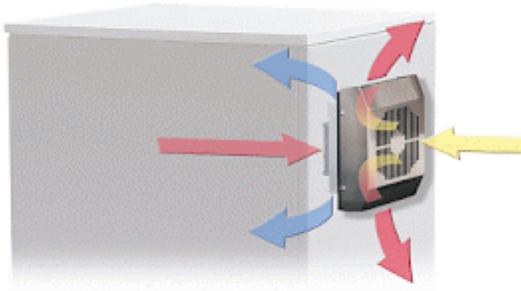

**Cut out Dimensions:**

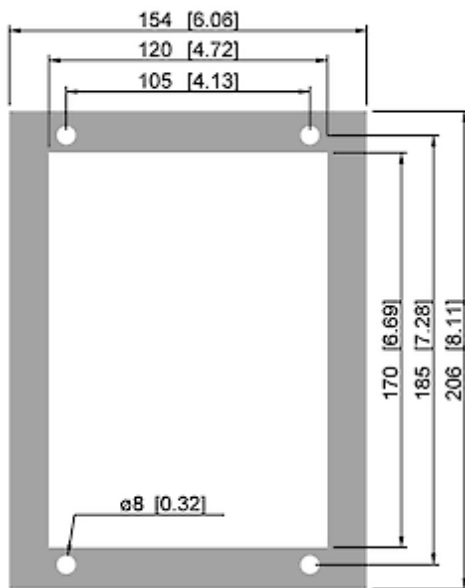

## Order Information

<b>Stainless steel AISI 316 (V4A) housing part no.</b>	30503034
<b>Verpackungsmaße</b>	244 x 142 x 159 mm
<b>Bruttogewicht</b>	4 kg
<b>Taric code</b>	84158300