

## Thermoelectric cooler



### Description

<b>Order Number:</b>	388708-3
<b>Brand Name:</b>	SOLITHERM PELTIER
<b>Housing Material:</b>	Stainless steel AISI 304 (V2A)
<b>Ingress protection to EN 60 529:</b>	IP 66 / UL Type 12, 4, 4X
<b>Note:</b>	Das Anziehdrehmoment der Schrauben muß 4.5 Nm betragen. Niehoff Material Nr. 388708-3
<b>Approvals:</b>	CE, cURus

## Technical data

<b>Cooling capacity 95F/95F:</b>	75 W
<b>Air volume flow (system / unimpeded):</b>	Ambient air circuit: 116 / 306 m <sup>3</sup> /h Cabinet air circuit: 58 / 182 m <sup>3</sup> /h
<b>Operating temperature range:</b>	-4°F - 158°F
<b>UL temperature range:</b>	-4°F - 149°F
<b>Mounting:</b>	Halbeinbau / Wandanbau
<b>Dimension H x W x D:</b>	250 x 203 x (86+74) mm
<b>Cut out dimensions:</b>	210 x 160 mm
<b>Voltage / Frequency:</b>	24 V DC
<b>Current 95F95F:</b>	4.6 A
<b>Starting current:</b>	6.9 A
<b>Max. current:</b>	5.3 A
<b>Power consumption:</b>	110 W
<b>Max. power:</b>	127 W
<b>Fuse:</b>	8 A (T)
<b>Connection:</b>	6 - poliger Anschlussstecker

**Performance graph:**

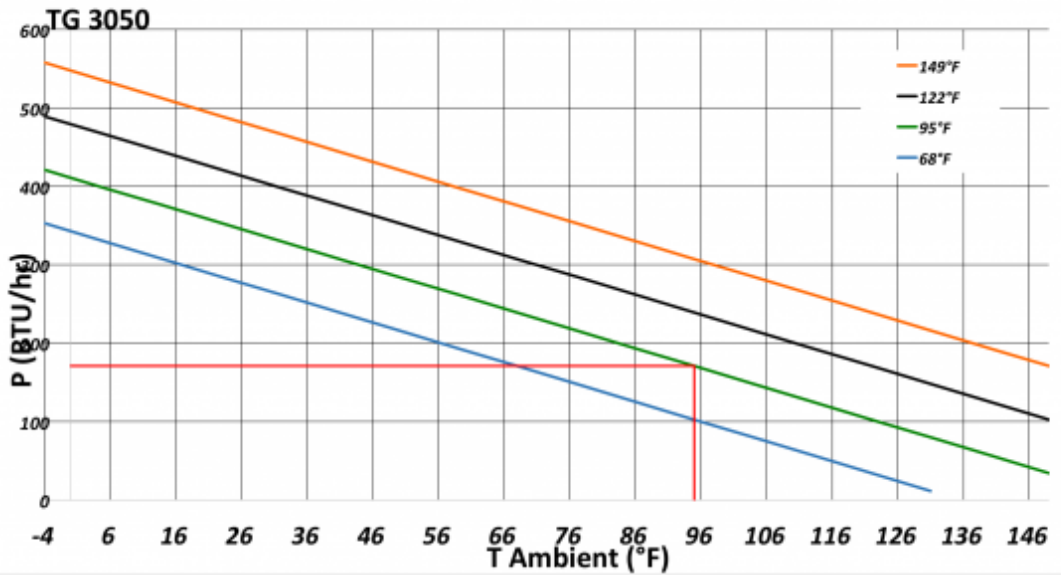

**Air flow:**

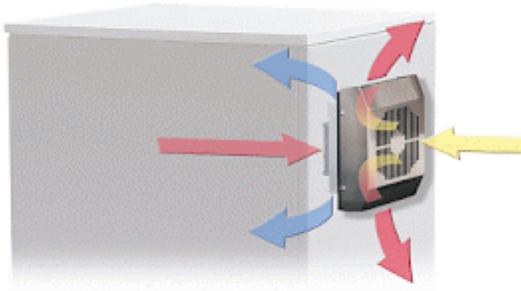

**Cut out Dimensions:**

